

DOWNTOWN DEERFIELD

FOR LEASE: 728 N. Waukegan Road • Deerfield, IL



**UP TO 3,212 SQUARE FEET AVAILABLE
DEMISABLE TO 2,000 SQUARE FEET**

The Shops at Deerfield Square

- Brand new retail spaces adjacent to Sephora and Warby Parker
- 17 foot ceilings throughout
- Massive outdoor patio
- Most prominent location within Downtown Deerfield with two-story presence
- Located one block from the Deerfield Metra Station and 1.5 miles to I-294/I-94

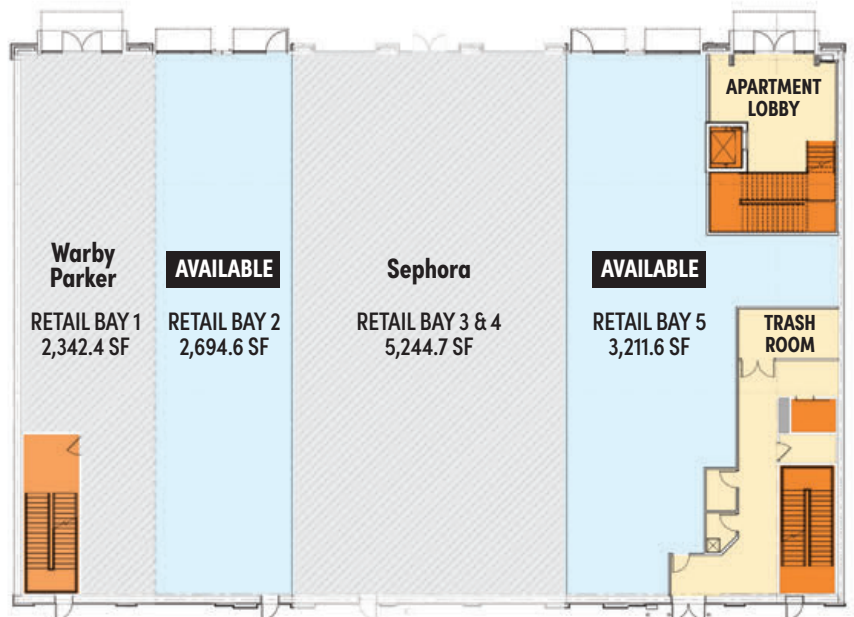

FOR EXCLUSIVE LEASING INFORMATION PLEASE CONTACT:

Chris Siavelis
csiavelis@crmproperties.com

Jeffrey Malk
jmalk@crmproperties.com



847-948-6500

All information contained herein is deemed reliable but is subject to errors, omissions, change in status or withdrawal without notice

DOWNTOWN DEERFIELD

FOR LEASE: 728 N. Waukegan Road • Deerfield, IL



FOR EXCLUSIVE LEASING INFORMATION PLEASE CONTACT:

Chris Siavelis
csiavelis@crmproperties.com

Jeffrey Malk
jmalk@crmproperties.com



847-948-6500

All information contained herein is deemed reliable but is subject to errors, omissions, change in status or withdrawal without notice