

# DOWNTOWN DEERFIELD

FOR LEASE: 728 N. Waukegan Road • Deerfield, IL



## 13,000 SQUARE FEET AVAILABLE The Shops at Deerfield Square

- Brand new retail spaces with contemporary storefronts, demisable to 2,342 square feet
- 17 foot ceilings throughout
- Massive outdoor patio
- Most prominent location within Downtown Deerfield with two-story presence
- Located one block from the Deerfield Metra Station and 1.5 miles to I-294/I-94

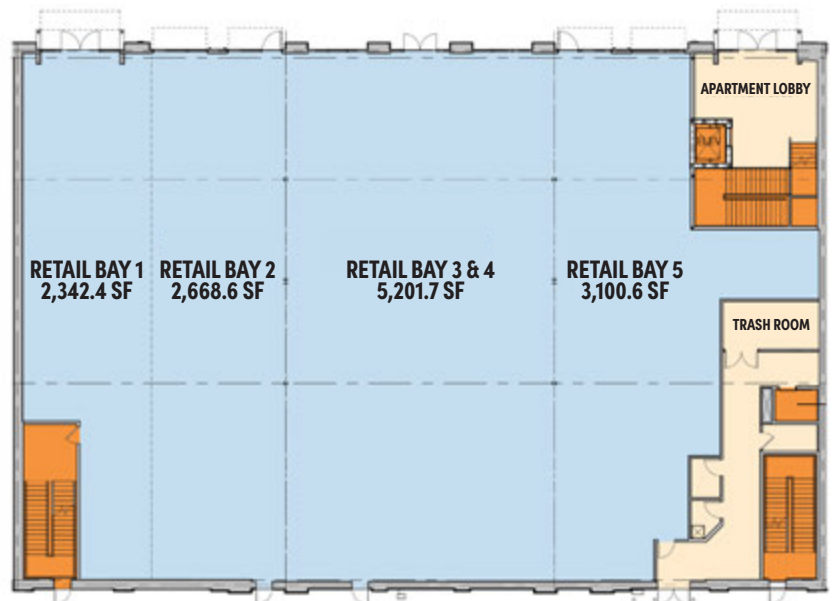

FOR EXCLUSIVE LEASING INFORMATION PLEASE CONTACT:

**Chris Siavelis**  
csiavelis@crmproperties.com

**Jeffrey Malk**  
jmalk@crmproperties.com



**847-948-6500**

All information contained herein is deemed reliable but is subject to errors, omissions, change in status or withdrawal without notice



# DOWNTOWN DEERFIELD

FOR LEASE: 728 N. Waukegan Road • Deerfield, IL

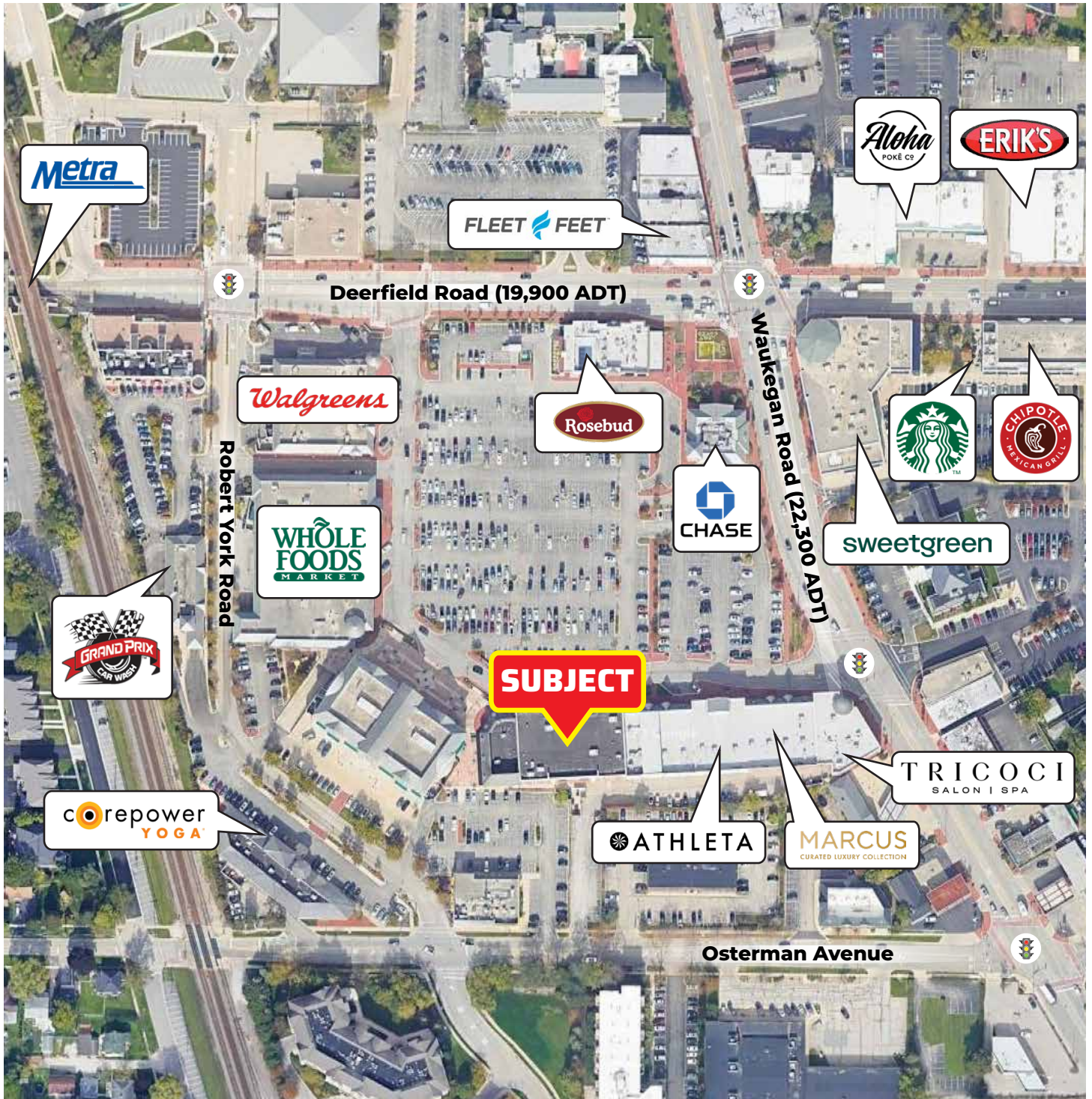

FOR EXCLUSIVE LEASING INFORMATION PLEASE CONTACT:

**Chris Siavelis**  
csiavelis@crmproperties.com

**Jeffrey Malk**  
jmalk@crmproperties.com

**847-948-6500**



All information contained herein is deemed reliable but is subject to errors, omissions, change in status or withdrawal without notice