

# CLYBOURN CORRIDOR

## FOR LEASE: 1548 N Fremont • Chicago, IL



## 9,000 SQUARE FEET AVAILABLE

### The Shops on Fremont • Divisible to 3,000 square feet

- 28 surface parking spaces in front
- 18 foot ceiling height
- Visibility and pylon signage on North Avenue
- Adjacent to Williams Sonoma and within one block of retail tenants Whole Foods, REI and Nordstrom Rack
- Former Firestone being replaced with new high-end furniture concept
- Located at the northwest corner of Fremont and Weed Street

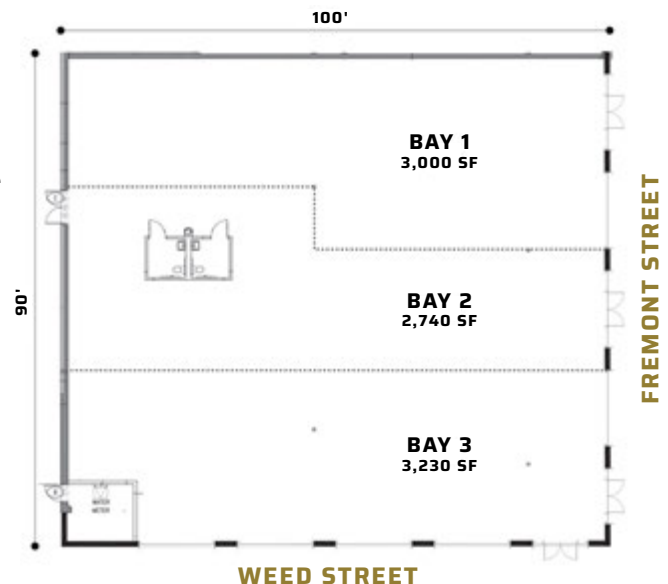

FOR EXCLUSIVE LEASING INFORMATION PLEASE CONTACT:

**Chris Siavelis**  
csiavelis@crmproperties.com

**Jeffrey Malk**  
jmalk@crmproperties.com



**847-948-6500**

All information contained herein is deemed reliable but is subject to errors, omissions, change in status or withdrawal without notice

# CLYBOURN CORRIDOR

## FOR LEASE: 1548 N Fremont • Chicago, IL



FOR EXCLUSIVE LEASING INFORMATION PLEASE CONTACT:

**Chris Siavelis**  
csiavelis@crmproperties.com

**Jeffrey Malk**  
jmalk@crmproperties.com

**847-948-6500**



All information contained herein is deemed reliable but is subject to errors, omissions, change in status or withdrawal without notice